

TENDER DOCUMENT

For

**CIVIL CONSTRUCTION AND INTERIOR WORK
OF AGRISTACK BUILDING****PREAMBLE**

PROJECT : CIVIL CONSTRUCTION AND INTERIOR WORK OF
AGRISTACK BUILDING

LOCATION : KORATTY SERVICE CO-OPERATIVE
BANK LTD.NO.590
KORATTY,PO
THRISSUR, KERALA – 680 308

COMPLETION : WITHIN 10 WEEKS FROM DATE AGREEMENT

CONTENTS

ARTICLE	DESCRIPTION	PAGE
V1.1	DEFINITIONS	
V1.2	TENDER CONDITIONS ELIGIBILITY / QUALIFICATION	
V1.3	FORM OF TENDER	
V1.4	GENERAL CONDITIONS	
V1.5	CONDITIONS	



Place : Koratty

Date :

for Koratty Service Co-operative Bank Ltd.
For KORATTY SERVICE CO-OPERATIVE BANK
No. 590

Sanil Kumar N.G.

Authorised Signatory

ARTICLE 1**DEFINITIONS**

For this Tender, terms set forth in this **Article 1.1**, when employed in singular or plural form, are defined to mean, unless the context otherwise requires, the following.

- 1.1 Project** means construction of **276.79 M²** Agristack Building as per Drawing No. LSGD 1.1A and the specifications given as the Annex.1 at the premises of **KORATTY SERVICE CO-OPERATIVE BANK NO.590, KORATTY.PO, THRISSUR, KERALA - 680308**
- 1.2 Civil Construction** means and includes Plinth, PCC Floor, Walls, Workers Toilet block, Septic tank, etc., as detailed in **Drg.No. LSGD 1.1A** attached as Annex.1 & Estimation given attached as Annex 2
- 1.3 Bidder/Contractor** means, the Eligible Person / Firm / Co-operative Society or Company who had tendered for **Project** and has been selected to undertake completion of **Project**
- 1.4 Offer** means sealed offer based on this Tender No.2246_T1/2023 from **Bidder/Contractor** for undertaking **Civil Construction of Project**
- 1.5 Contract Document** means and includes, Tender Document and acceptance thereof, including conditions, specifications, designs, drawings and formal **Agreement**.
- 1.6 Contract Value** means the fixed amount, **including all taxes** and duties, offered by **Bidder/Contractor** to complete **Civil Construction of Project**.
- 1.7 Earnest Money Deposit (EMD)** (equivalent of 2 % of **Contract Value** by Demand Draft from a Scheduled Bank, to be submitted along with **Offer**) is to ensure that **Bidder/Contractor** does not submit a dummy **Offer** or back out at time of Tender opening.

EMD provided by successful **Bidder/Contractor** is retained against **Security Deposit**. In the event of successful **Bidder/Contractor** backing out, respective **EMD** is forfeited.

EMDs from unsuccessful **Bidders/Contractors** are returned within 15 days from date of opening of the **Tender**
- 1.8 Time of completion** means the period in which the **Civil Construction of Project** is to be completed from the date of signing the **Contract**
- 1.9 Project Officer** means the executive, duly authorised by **Kaoratty Service Co-Operative Bank** as in charge of execution of **Civil Construction of Project** and to whom **Bidder/Contractor** will report all technical aspects of **Civil Construction of Project**
- 1.10 Certificate of Practical Completion** is the certificate issued by **Project Officer**, confirming that **Bidder/Contractor** has **completed** the contractual obligations as per **Offer**.
- 1.11 Defects liability period** of 12 months is a period of time following **Practical Completion**. If any defect during this period is observed and notified by **Project Officer**, **Bidder/Contractor** shall rectify the same at his cost.

1.12 Performance Guarantee of 5% of **Contract Value** and for a period of 12 months from date of **Completion Certificate**, is against due and faithful completion of **Project**.

After adjusting the **EMD**, balance of **Performance Guarantee** may be recovered by percentage deduction from the successful **Bidder/ Contractor's**, respective "on account" bills.

1.13 Performance Guarantee amount shall be returned to the **Bidder/Contractor** after expiry of **Defects liability period**, (subject to **Bidder/Contractor** rectifying defects, if any during the period) against **No Claim Certificate** issued by **Project Officer**.

1.14 Agreement, which is part of **Contract Documents**, means the formal Agreement executed between **Secretary, Koratty Service Co-Operative Bank** and **Bidder/Contractor**. **Agreement** will govern all terms and conditions of completion of **Project**.

1.15 Drawings, which is part of **Contract Documents**, mean the drawings which will form part of **Project** under Permit No..... Issued by Koratty Gram Panchayath, sanctioning the construction **Project**.

1.16 Specifications mean the specifications for Materials and Civil Construction specified in **Drawings** which may be amplified, added to or superseded by written instruction of **Project Officer** during **Time of Completion**.

ARTICLE 2

TENDER CONDITIONS

2.1 ELIGIBILITY / QUALIFICATION

Bidder/Contractor must have Experience in Civil Construction of Industrial Buildings and should have constructed at least one building completed within the last three years, cost of construction of which should be above Rs. 50 lacs.

If so desired by **Koratty Service Co-Operative Bank**, **Bidder/Contractor** will make arrangements for **Project Officer** to see the Building.

SL.no	Building Site	Completed capacity	year of completion
1			
2			

2.2 Permissions/Approvals

Bidder/Contractor must have all necessary statutory and valid Permissions/Approvals as well as Registration for WCT (Work Contract, Tax), Service Tax etc. necessary, to undertake **Project**.

2.3 Construction Material

Materials as per specifications in Tender and brought on site by **Bidder/ Contractor** shall be used in construction only after inspection and approval by **Project Officer**

ARTICLE 3

FORM OF TENDER

3.1 Competence

If **Bidder/Contractor** is,

An individual, **Offer** shall be signed with full name and complete address, both permanent address and communication address.

A partnership firm, **Offer** shall be signed by the Managing Partner of the firm. Notarised copy of Registered Partnership Deed of the firm shall be submitted along with **Offer**.

A company incorporated under the companies Act (1 of 1956), **Offer** shall be signed by its Managing Director duly authorised on their behalf and shall bear the official seal of the company.

3.2 Covering Letter

Offer shall have a covering letter, signed and sealed, in the following format, typed in the letterhead of **Bidder/Contractor**.

**ESTIMATE FOR KORATTY SERVICE COOPERATIVE BANK
PROJECT: INTERIOR WORK OF VALLUMURI BRANCH**

SL.NO	DESCRIPTION	QTY	RATE	AMOUNT
1	CONFERENCE TABLE Providing and fixing of tables using 16 mm thick 710grade marine ply frame and 9 mm paneling of approved quality with 1mm thick mica, including drawers with <i>ebco/Haffle</i> fittings.	LS		
2	OFFICE TABLE Providing and fixing of tables using 16 mm thick 710grade marine ply frame and 9 mm paneling of approved quality with 1mm thick mica, including drawers with <i>ebco/Haffle</i> fittings.	LS		
3	PLYWOOD PARTITIONS Providing and fixing of all partitions using 16mm 710grade marine ply frame and 9 mm double side paneling of approved quality with 1mm thick mica	200 SQFT		
4	V BOARD PARTITION Providing and fixing of all partitions using 6mm v board and all fittings of SAINT GOBIN	800 SQFT		
5	TRESS WORK Structural steel work bolted or welded in built up sections, trusses and framed work, including cutting, hoisting, fixing in position and applying a priming coat of approved primer all complete. Gi sheet .35 TATA bhushan and rain water gutter euro guard square pathi.	1200 SQFT		
6	FIXED GLASS PARTITION Providing and fixing of 10mm thick toughened glass (Saint Gobbain) of DORMA,OZONE.	950 SQFT with fittings		
7	GLASS DOOR Providing and fixing of 10mm thick toughened glass (Saint Gobbain) with fittings of DORMA, OZONE	5NOS		
8	ALUMINIUM WINDOW (ALGERIA SECTION)	4NOS		
9	CLERIKAL COUNTER (WORKSTATION AREA) Providing and fixing of tables using 16 mm thick 710grade marine ply frame and 9 mm paneling of approved quality with 1mm thick mica, including drawers with <i>ebco/Haffle</i> fittings.	10NOS		
10	CEILING Providing and fixing of gypsum ceiling.(all materials of saint gobbain)	2500SQFT		
11	PAINTING Putty work and painting as per plan using Asian paints approved colour	LS		
13	ELECTRICAL WORK	LS		
TOTAL				
GST 18%				
G.TOTAL				
ROUND OFF				
IN WORDS				



For KORATTY SERVICE CO-OPERATIVE BANK Ltd
No. 590

Sanil Kumar N.G.
Secretary

PROPOSED PLAN

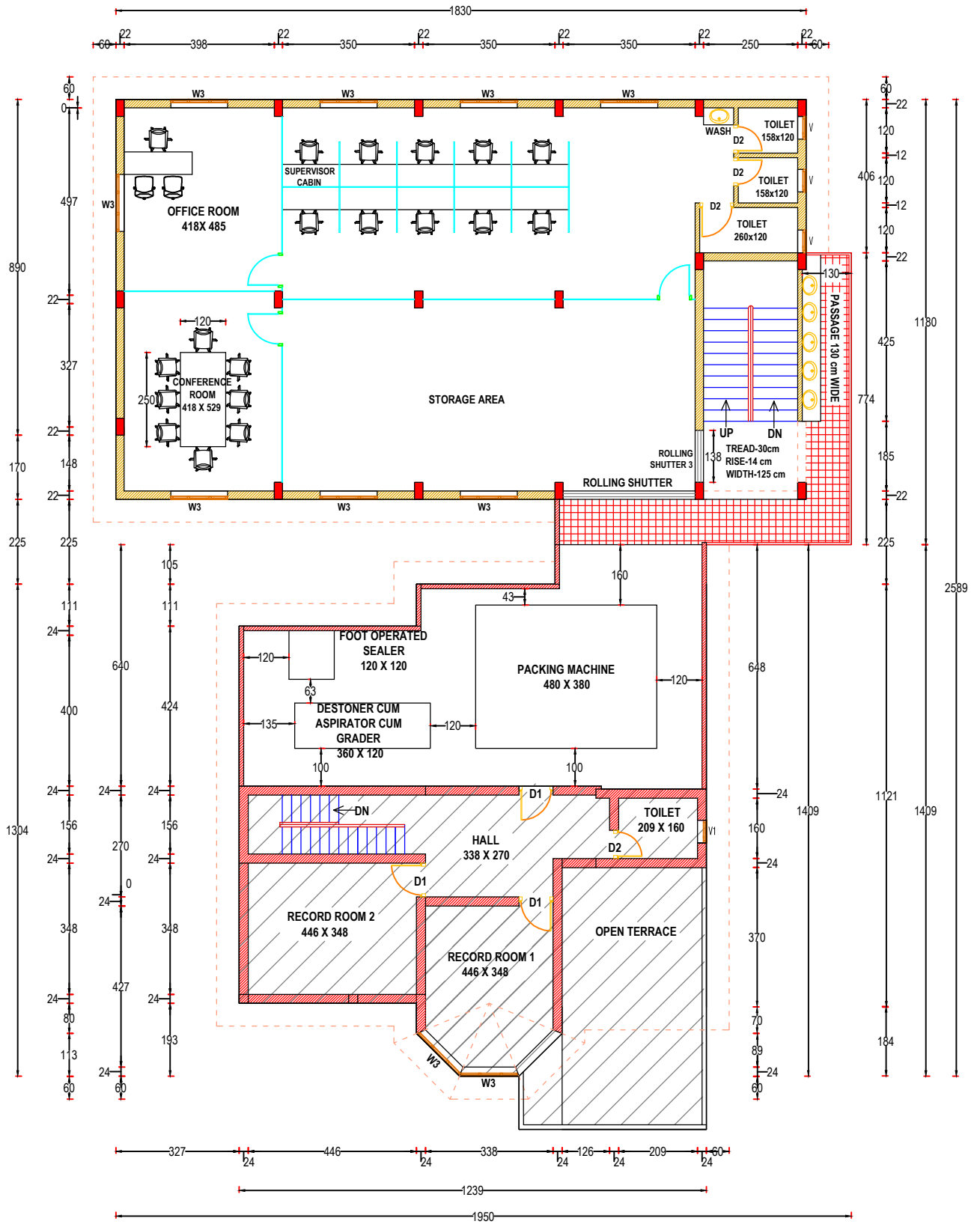

FIRST FLOOR PLAN-276.77 m²